

CODE/ADDENDA 2010/2011A APPROVED  
 RELEASED FOR PRODUCTION  
 Q.C. \_\_\_\_\_ DATE \_\_\_\_\_

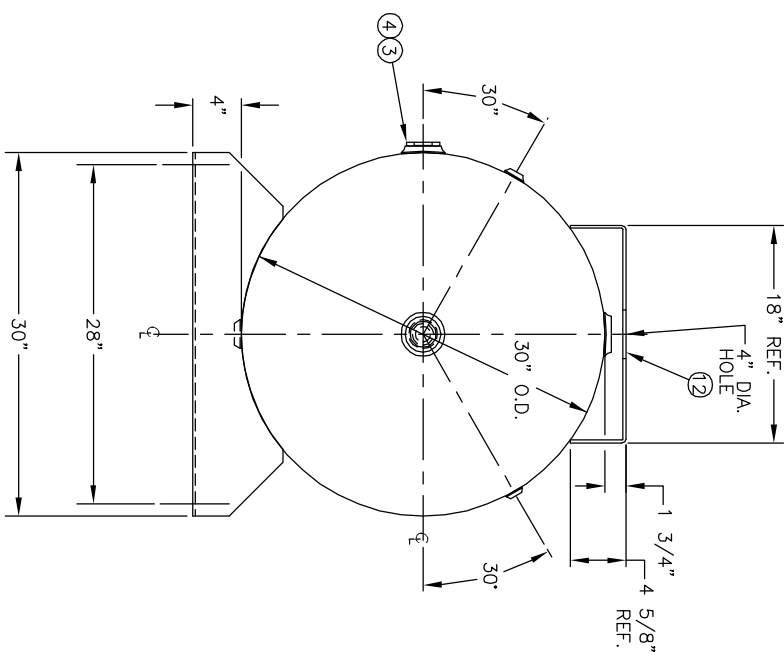
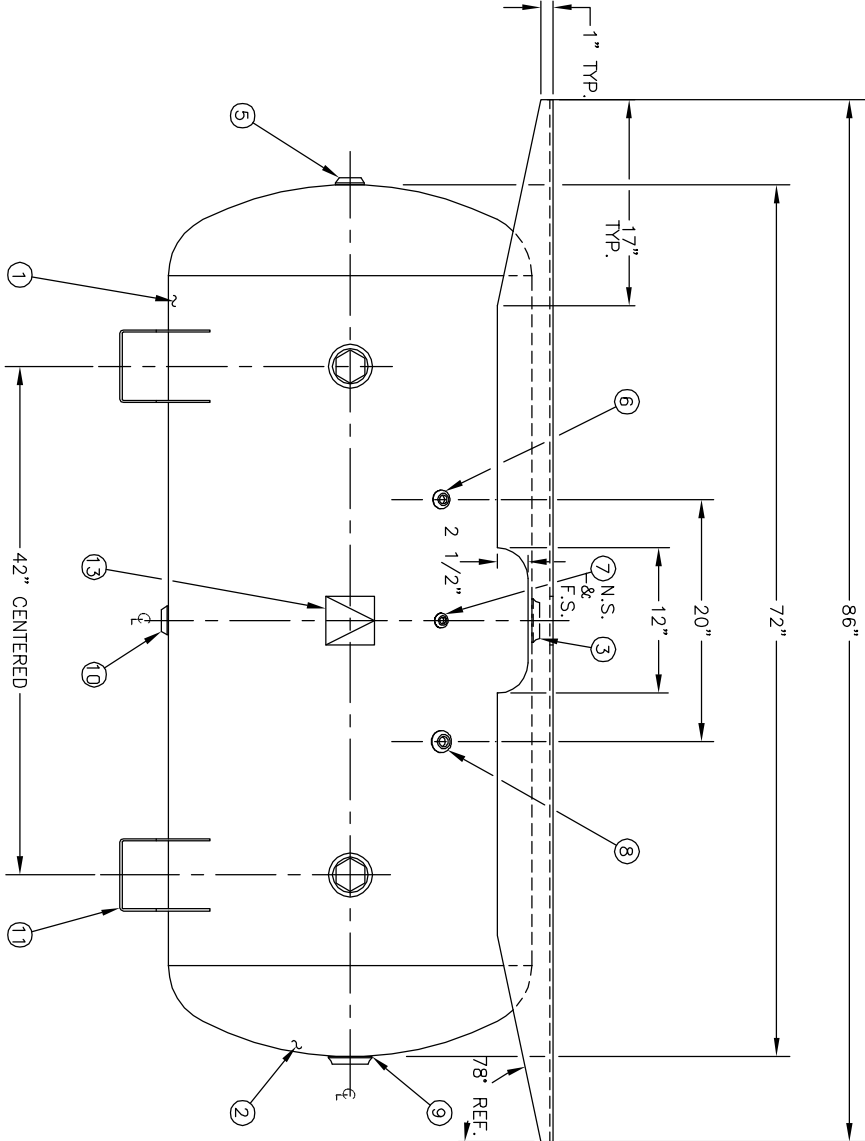

| NO. | QTY | DESCRIPTION                   | SPEC      | SUB-DWG. |
|-----|-----|-------------------------------|-----------|----------|
| 3   | 3   | 2"-NPT 1500# RADIAL FLANGE    | SA-181-70 |          |
| 4   | 2   | 2"-NPS PLUG                   | SA-181-70 |          |
| 5   | 1   | 1"-NPT 1500# FLAT FLANGE      | SA-181-70 |          |
| 6   | 1   | 3/8"-NPT 1500# FLAT FLANGE    | SA-181-70 |          |
| 7   | 2   | 1/4"-NPT 1500# FLAT FLANGE    | SA-181-70 |          |
| 8   | 1   | 1/2"-NPT 1500# FLAT FLANGE    | SA-181-70 |          |
| 9   | 1   | 2"-NPT 1500# FLAT FLANGE      | SA-181-70 |          |
| 10  | 1   | 1"-NPT 1500# RADIAL FLANGE    | SA-181-70 |          |
| 11  | 2   | STANDARD SADDLE FOR 30" DIA.  |           | A84452   |
| 12  | 1   | 1/4" X 26 1/4" X 86" PLATFORM | C1008     |          |
| 13  | 1   | ASME DATA PLATE               | C1010     |          |

SPECIFICATIONS

O.D. 30 LGH. 72 SH. HD.  
 MAMP 200 PSI @ 650 F  
 RT- MDMT -20 F @ 200 PSI CAL. 200 SA. 50.9  
 EXMT TEST Wt. 700# CUFT. 26.7  
 CRN F0628.1C HD  
 WELD DETAILS: M-1932  
 STD. TOLERANCES (UNLESS OTHERWISE NOTED): M-2461



200 GALLON  
 STD. HORIZ. W/EXTENDED PLATFORM  
 Q:\3000

|          |      |             |        |
|----------|------|-------------|--------|
| DRAWN BY | DATE | SCALE:      | NONE   |
| JR       |      | DRAWING NO. | 302701 |
| APP. BY  | DATE |             |        |
| AMA      |      |             |        |

| SM | DATE | BY  | REVISION |
|----|------|-----|----------|
| 4  |      | JR  |          |
| 5  |      | AMA |          |